

ZBF® 株洲珍珠轴承有限责任公司
ZBF BEARING CO., LTD.



中国·湖南·株洲
ZHUSHOU. HUNAN. CHINA

ZBF

株洲珍珠轴承有限责任公司
ZBF BEARING CO., LTD.

圆锥滚子轴承 TAPER ROLLER BEARINGS

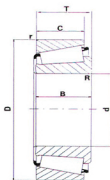

轴承型号 Bearing No	外形尺寸 Dimensions							基本额定负荷 Basic Load Ratings		重量 Weight
								动负荷 Dynamic	静负荷 Static	
	d	D	T	B	C	R	r	Cr	Cor	
	mm							KN	KN	
27709K	45	100	32	29	20	2.5	2.0	98.55	113.87	1.04
27309	45	100	27.25	25	18	2.5	2.0	95.6	113.8	0.944
7813	65	110	30.5	30	24	3.0	2.0	109	163	1.129
568331	31.75	76.2	25.4	25.4	19.845	1.5	1.0	75.5	83.7	0.557
326332	21.986	40.981	14.37	14.43	11.47	1.4	1.0	19.6	23.2	0.085
02297W	48.585	87.982	21.5	21.43	16.67	0.8	1.0	82.67	106.38	0.537
536991A	44.45	92/82.931	25.8	25.4	22.145/18.145	2.5	1.0	75.988	110.716	0.639
537598B	31.75	76.2/66	29.5	28.45	22.928/19.84	1.0	0.8	95.256	104.6	0.626
LM11749/LM11710	17.462	39.878	13.843	14.605	10.668	1.3	1.3	20.70	22.80	0.085
LM11949/LM11910	19.050	45.237	15.494	16.637	12.065	1.3	1.3	29.00	30.30	0.121
L44649/L44610	26.988	50.292	14.224	14.732	10.668	3.5	1.3	26.70	32.50	0.119
LM501349/LM501310	41.275	73.431	19.558	19.812	14.732	3.5	0.8	51.00	69.50	0.328
JLM104948/JLM104910	50.000	82.000	21.500	21.500	17.000	3.0	0.5	69.50	94.00	0.417
331274(L45449/10)	29.000	50.292	14.224	14.732	10.668	2.0	1.0	28.63	36.40	0.110
15585/15520	28.000	57.150	17.462	17.462	13.495	3.0	1.3	37.70	42.71	0.193
29590/22	66.675	107.95	25.400	25.400	19.050	3.5	2.5	93.00	141.36	0.841
31305	25	62	18.25	17.0	13.0	1.5	1.5	41	46	0.260
31306	30	72	20.75	19.0	14.0	1.5	1.5	52	60	0.389
31307	35	80	22.75	21.0	15.0	2.0	1.5	66	77	0.508
31308	40	90	25.25	23.0	17.0	2.0	1.5	81	96	0.722
31309	45	100	27.25	25.0	18.0	2.0	1.5	96	114	0.950
31310	50	110	29.25	27.0	19.0	2.5	2.0	108	128	1.230
31311	55	120	31.50	29.0	21.0	2.5	2.0	130	158	1.560
30309XA	45	100	32.00	29.0	20.0	2.0	1.5	98.55	113.87	1.040
33113X	65	110	30.50	30.0	24.0	2.5	1.5	109	163	1.129



[Http://www.zbfbearing.com](http://www.zbfbearing.com)

ZBF

株洲珍珠轴承有限责任公司
ZBF BEARING CO., LTD.

圆锥滚子轴承 TAPER ROLLER BEARINGS

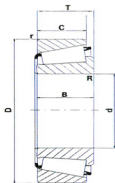

轴承型号 Bearing No	外形尺寸 Dimensions							基本额定负荷 Basic Load Ratings		重量 Weight
								动负荷 Dynamics	静负荷 Static	
	d	D	T	B	C	R	r	Cr	Cor	
	mm							KN	KN	
32005	25	47	15.00	15	11.5	0.6	0.6	28	34.1	0.110
32006	30	55	17.00	17.0	13.0	1.0	1.0	40	45	0.175
32007	35	62	18.00	18.0	14.0	1.0	1.0	48	58	0.221
32008	40	68	19.00	19.0	14.5	1.0	1.0	55	62	0.270
32009	45	75	20.00	20.0	15.5	1.0	1.0	65	76	0.340
32010	50	80	20.00	20.0	15.5	1.0	1.0	67	79	0.360
32011	55	90	23.00	23.0	17.5	1.5	1.5	90	110	0.552
32012	60	95	23.00	23.0	17.5	1.5	1.5	92	114	0.589
32013	65	100	23.00	23.0	17.5	1.5	1.5	95	117	0.626
32014	70	110	25.00	25.0	19.0	1.5	1.5	98	120	0.853
30202	15	35	11.75	11	10	0.6	0.6	12	12	0.055
30203	17	40	13.25	12	11	1.0	1.0	20.7	21.9	0.0798
30204	20	47	15.25	14	12	1.0	1.0	28.2	30.6	0.1256
30205	25	52	16.25	15	13	1.0	1.0	32.2	37.0	0.153
30206	30	62	17.25	16.0	14.0	1.0	1.0	43	50	0.231
30207	35	72	18.25	17.0	15.0	1.5	1.5	54	63	0.325
30208	40	80	19.75	18.0	16.0	1.5	1.5	63	74	0.411
30209	45	85	20.75	19.0	16.0	1.5	1.5	67	83	0.467
30210	50	90	21.75	20.0	17.0	1.5	1.5	73	92	0.526
30211	55	100	22.75	21.0	18.0	2.0	1.5	91	114	0.709
30212	60	110	23.75	22.0	19.0	2.0	1.5	103	130	0.888
30213	65	120	24.75	23.0	20.0	2.0	1.5	120	152	1.118
30214	70	125	26.75	24.0	21.0	2.0	1.5	132	173	1.238
30304	20	52	16.25	15	13	1.5	1.5	33.1	33.2	0.165
30305	25	62	18.25	17.0	15.0	1.5	1.5	46	48	0.260

[Http://www.zbfbearing.com](http://www.zbfbearing.com)



ZBF

株洲珍珠轴承有限责任公司
ZBF BEARING CO., LTD.

圆锥滚子轴承 TAPER ROLLER BEARINGS

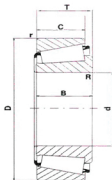

轴承型号 Bearing No	外形尺寸 Dimensions							基本额定负荷 Basic Load Ratings		重量 Weight
	d	D	T	B	C	R	r	动负荷 Dynamic	静负荷 Static	
								Cr	Cor	
	mm							KN	KN	Kg
30306	30	72	20.75	19.0	16.0	1.5	1.5	59	63	0.376
30307	35	80	22.75	21.0	18.0	2.0	1.5	75	83	0.514
30308	40	90	25.25	23.0	20.0	2.0	1.5	91	108	0.732
30309	45	100	27.25	25.0	22.0	2.0	1.5	108	130	0.962
30310	50	110	29.25	27.0	23.0	2.5	2.0	130	157	1.256
30311	55	120	31.50	29.0	25.0	2.5	2.0	153	187	1.598
30312	60	130	33.50	31.0	26.0	3.0	2.5	171	210	1.956
32205	25	52	19.25	18	16	1.0	1.0	36.4	43.2	0.182
32206	30	62	21.25	20.0	17.0	1.0	1.0	52	64	0.288
32207	35	72	24.25	23.0	19.0	1.5	1.5	71	89	0.440
32208	40	80	24.75	23.0	19.0	1.5	1.5	78	97	0.530
32209	45	85	24.75	23.0	19.0	1.5	1.5	81	104	0.576
32210	50	90	24.75	23.0	19.0	1.5	1.5	83	108	0.627
32211	55	100	26.75	25.0	21.0	2.0	1.5	108	142	0.839
32212	60	110	29.75	28.0	24.0	2.0	1.5	133	180	1.148
32213	65	120	32.75	31.0	27.0	2.0	1.5	161	221	1.525
32214	70	125	33.25	31.0	27.0	2.0	1.5	168	237	1.620
32305	25	62	25.25	20.0	20.0	1.5	1.5	62	69	0.365
32306	30	72	28.75	27.0	23.0	1.5	1.5	81	96	0.551
32307	35	80	32.75	31.0	25.0	2.0	1.5	99	119	0.752
32308	40	90	35.25	33.0	27.0	2.0	1.5	115	148	1.020
32309	45	100	38.25	36.0	30.0	2.0	1.5	145	189	1.383
32310	50	110	42.25	40.0	33.0	2.5	2.0	177	236	1.874
32311	55	120	45.50	43.0	35.0	2.5	2.0	203	271	2.350
32312	60	130	48.50	46.0	37.0	3.0	2.5	226	303	2.858



[Http://www.zbfbearing.com](http://www.zbfbearing.com)